

How to install a CISS onto an Epson PX660

1. Place the CISS on the right side of the printer (pic. 1) and straighten the pipe.

Check color order on printer sticker and on cartridges colored plugs. **In a case of mismatching the color order should be changed!**



pic. 1



pic. 2

2. Pull out the small plugs and carefully insert air filters into their place (pic. 2). Make sure to keep the plugs for further transportation of the printer with the CISS installed.

3. Plug in the printer to the electric network and select the language (pic. 3). After the carriage moves into the “cartridge change” position, unplug the printer from the electric network by pulling the power cable out of the socket.



pic. 3

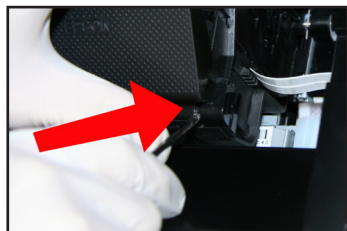

pic. 4

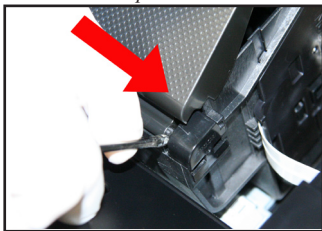

pic. 5

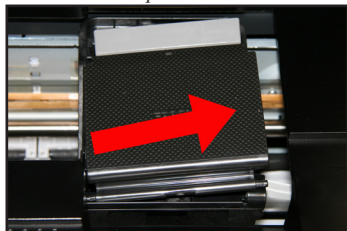

pic. 6

clip rightwards (pic. 5) until you have the possibility to remove the cover (pic. 6). Remove the cover. The printer will work even if the clip is broken.

5. In case you are installing the pipe as shown in (pic. 7) we recommend that you take the clip off and turn the pipe into the opposite direction (pic. 8).

6. Insert the cartridge block into the carriage

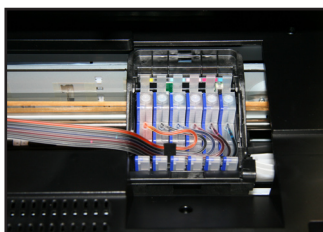

pic. 7

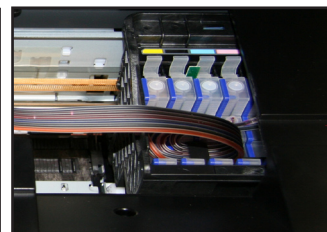

pic. 8

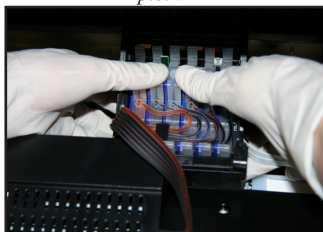

pic. 9

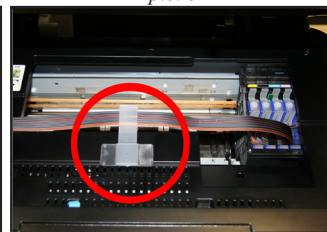

pic. 10

(pic. 9). Place the carriage in the center of the printer so that you can hold it with both hands and carefully push the cartridges down until they click in (pic. 9). Make sure that all the cartridges are properly clicked in.

7. Place the T bracket in the middle of the printer and fix the ink pipe into it (pic. 10). Make sure that there is no twist in the pipe to ensure the proper operation of the printer.

8. Move the carriage into the extreme left position (pic. 11) then to the extreme right position (pic. 12), check that there is no twist along the pipe and that it

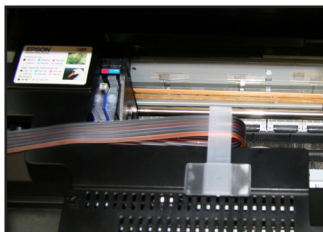

pic. 11



pic. 12

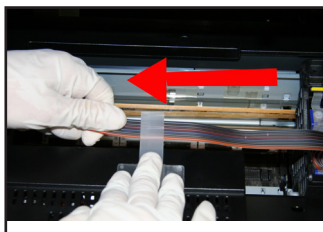

pic. 13

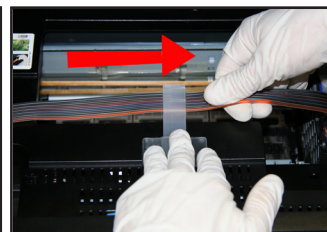

pic. 14

doesn't interfere with the movement of the carriage. The pipe should not be slack.

9. If the pipe is shorter than needed, pull it out in the needed direction (pic. 13, pic. 14).

10. Put a piece of paper or some scotch tape on the

place of the open lid sensor to fix it in the pressed position (pic. 15).

11. Place the pipe clip onto the case of the printer. Fix the ink pipe into the clip (pic. 16).

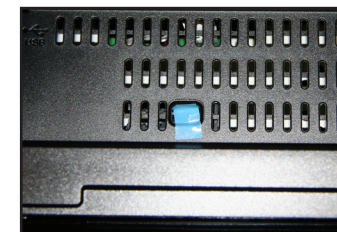

pic. 15

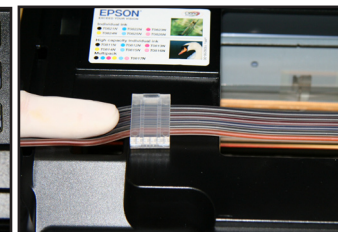

pic. 16

12. The ink tanks should be on the same level with the printer, not higher and not lower.

13. Plug in the printer to the electric network. Switch the printer on. Connect the printer to the computer, go to Start - Devices and printers, click the right mouse button on your printer and select Printing preferences – Maintenance – Nozzle check (pic. 17).

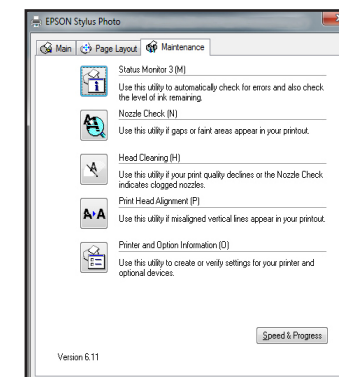

pic. 17

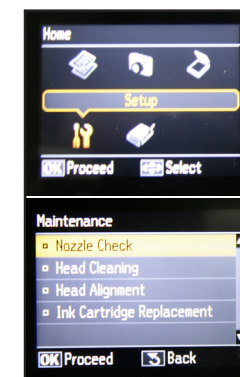

pic. 18

You can check the print head condition without using a computer by selecting the “Nozzle check” option in the service menu of your printer. If the test result is bad perform the “Head cleaning” procedure.

14. In order to transport the printer replace the air filters with the silicone plugs. Do not leave the printer without cartridges or a CISS, otherwise the print head may dry up. Any movement of the printer from one place to another should be performed with utmost care and compliance with the transportation rules, otherwise moving the tank may result in ink leaking into the printer which will disable the device.

Refilling and filling a CISS

Watch the ink level in the tanks carefully while using a CISS. When the ink level reaches the “red line” shown on the brand sticker follow these steps:

1. Open the big silicone plugs (pic. 20).
2. Use a syringe to extract the ink from the bottle (pic. 21).
3. Pour the ink into the big holes of the INK-



pic. 20



pic. 21

SYSTEM tank (pic. 22).

ATTENTION! Fill the colors according to the colored plugs on the tank. Wash the syringe after filling each color. Do not mix colors.

4. After filling the tank wipe the ink off the filling hole and close the plugs (pic. 23).

If you are filling the system for the first time and the



pic. 22



pic. 23

cartridges are not installed into the printer yet, do 1-3 and then:

5. With the help of a syringe with a medical needle poke through the silicone plug on the upper part of the cartridge and pull the air out until the ink comes into the syringe (pic. 24).

6. Take the syringe out and wipe the surface of the cartridge with a tissue to remove the residual ink. Repeat the procedure for each of the cartridges.

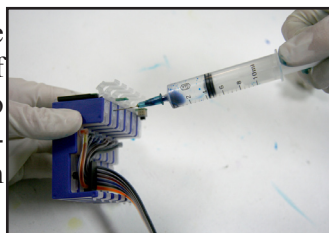

pic. 24

Resetting the ink level

1. If during operation the printer demands that cartridges be changed, the message “Ink cartridges not recognized” will appear on the screen (pic. 25).
2. Press the “OK” button on the printer panel

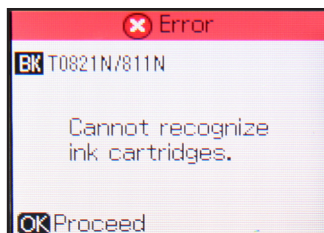

pic. 25



pic. 26

(pic. 26).

3. Lift the printer lid. The cartridge carriage should be in the cartridge change window. There is a green lobe with the ink level reset button above the cartridges.

4. Get hold of the ink level reset button, press it from



pic. 27

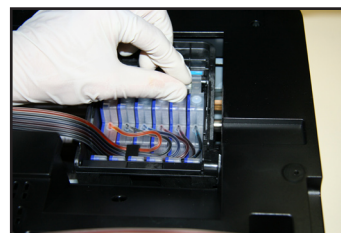

pic. 28

the back and hold it for 5 to 7 seconds (pic. 27, pic. 28).

5. To finish the ink level resetting procedure press the “OK” button (pic. 26).

6. The printer will be ready for operation in several minutes (pic. 29).

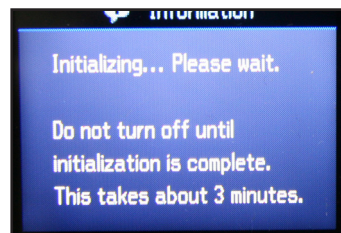

pic. 29

If you have any questions about installation or using of your product, please contact us:

support@inksystem.com inksystem.service

www.ink-system.eu 626-349-484

www.facebook.com/inksystemcom

www.youtube.com/inksystemcom



Thank you for choosing CISS from INKSYSTEM®. We recommend to read the manual before installing CISS onto your printer!



Warranty card

Product: Continuous Ink Supply System

Printer model:

CISS Serial №:

Printer serial №:

Purchasing date:

Warranty period: 24 month from purchase date.

I agree with warranty agreement.

I have no complaints for the product.

Client signature

Free Installation Certificate



This certificate allows you to install CISS at any certified service center of INKSYSTEM® for free.

Sales company

Seal